

**SEISMIC V**



Fig.1 SEISMIC-V booklet

**RESEARCH PROJECTS**

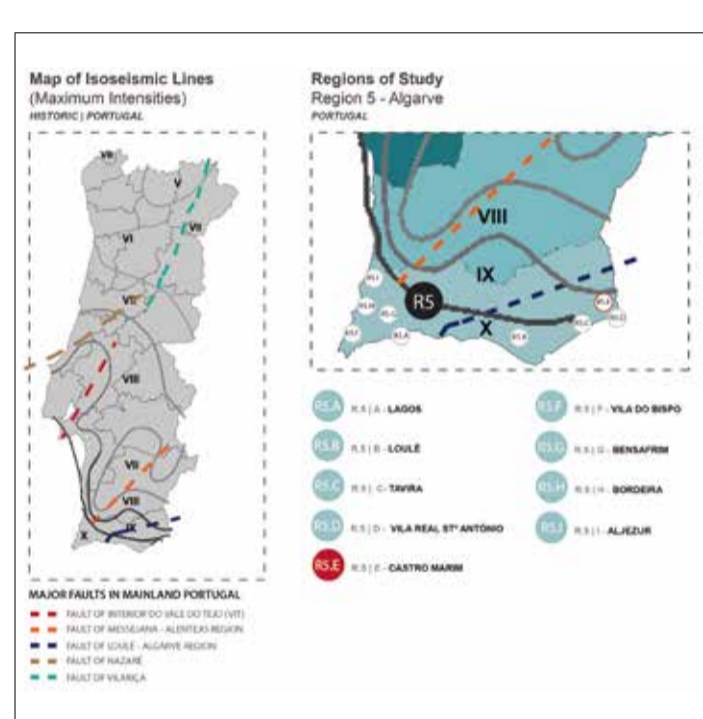

Fig.2 Maps of seismic intensity in Portugal

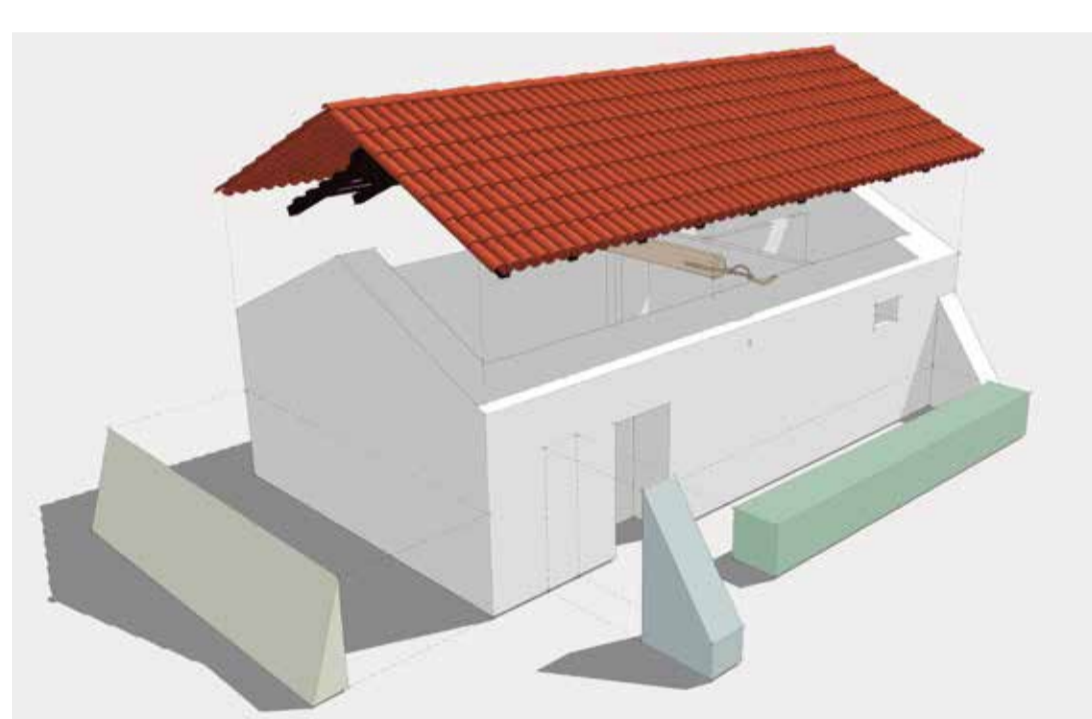

Fig.3 Reconstruction of 3D elements that reinforce Portuguese vernacular architecture



Fig.4 Reinforced elements in Alentejo vernacular architecture.

*Local seismic culture in Portugal.*

**PROJECT-LEADER:**

Escola Superior Gallaecia/ Ci-ESG (Portugal)

**PARTNERS:**

- UA/ University of Aveiro - Engineering Department
- UM/ University of Minho - Engineering Department

**SCOPE:**

All scientific domains 2012: Environment, Territory and Population – Architecture, FCT Program

**DURATION:**

2013-1015  
esg.pt/seismic-v

The SEISMIC-V Project focused on the identification of earthquake-resistant elements, which can be tracked through vernacular architecture, still-in-use. SEISMIC-V project also aimed to verify if the concept of ‘Local Seismic Culture’ is still consistent and active in Portugal.

The project sought to be a useful tool in the understanding and application of traditional techniques, valuing its identity, according to the current safety parameters. The research contributed to the awareness and protection of the local seismic culture. The results of the project provided data for the seismic reinforcement of the architectural components of the vernacular heritage still in use, which in case of an earthquake could save lives.

**RESULTS:**

- 1 International Conference - CIAV2013 (<https://esg.pt/ciav2013>);
- 2 International indexed publications [distributed to all Portuguese architecture and engineering universities (state and private), Portuguese municipalities, and universities from more than 50 countries on 5 continents];
- 1 graphic manual of reinforcement and prevention (distributed to 309 Portuguese municipalities);
- and 3 scientific seminars.

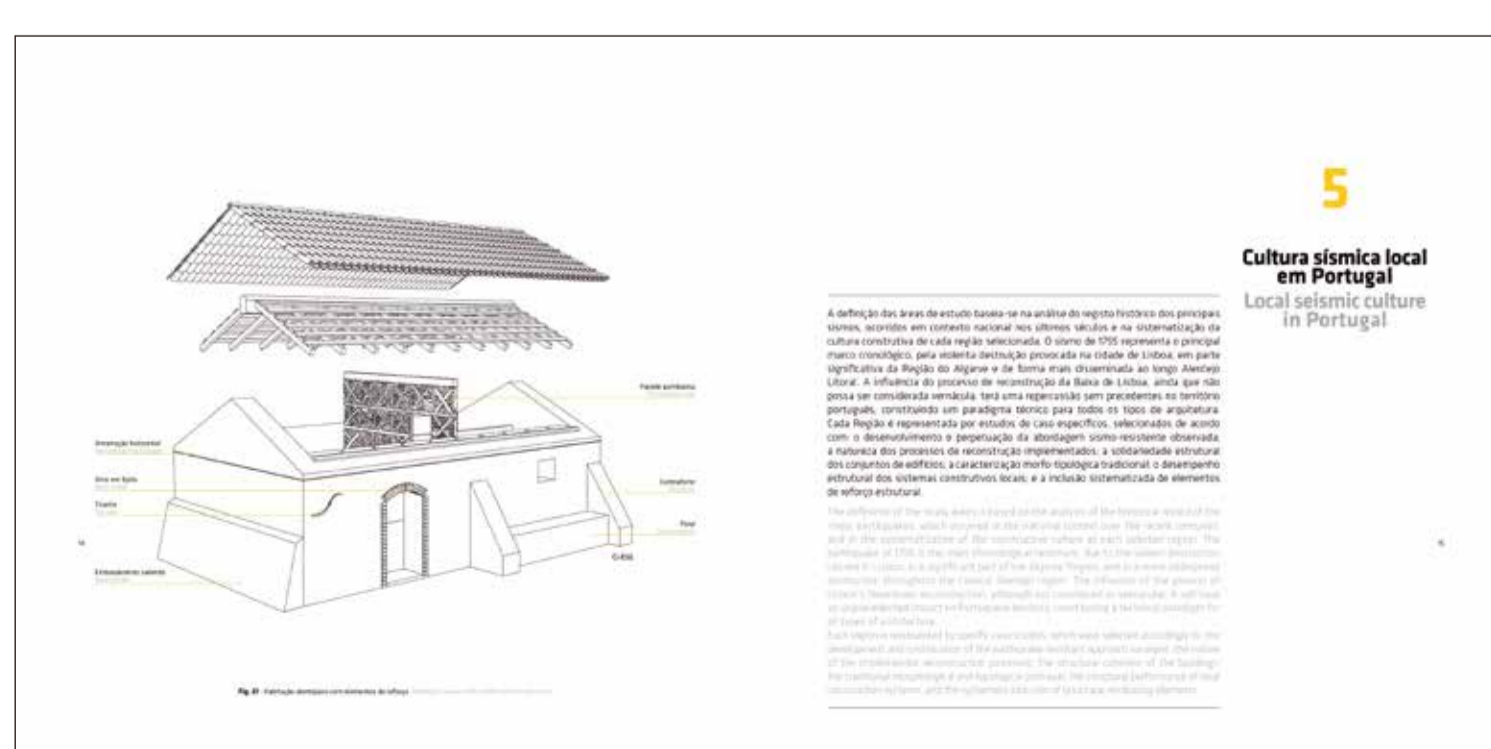
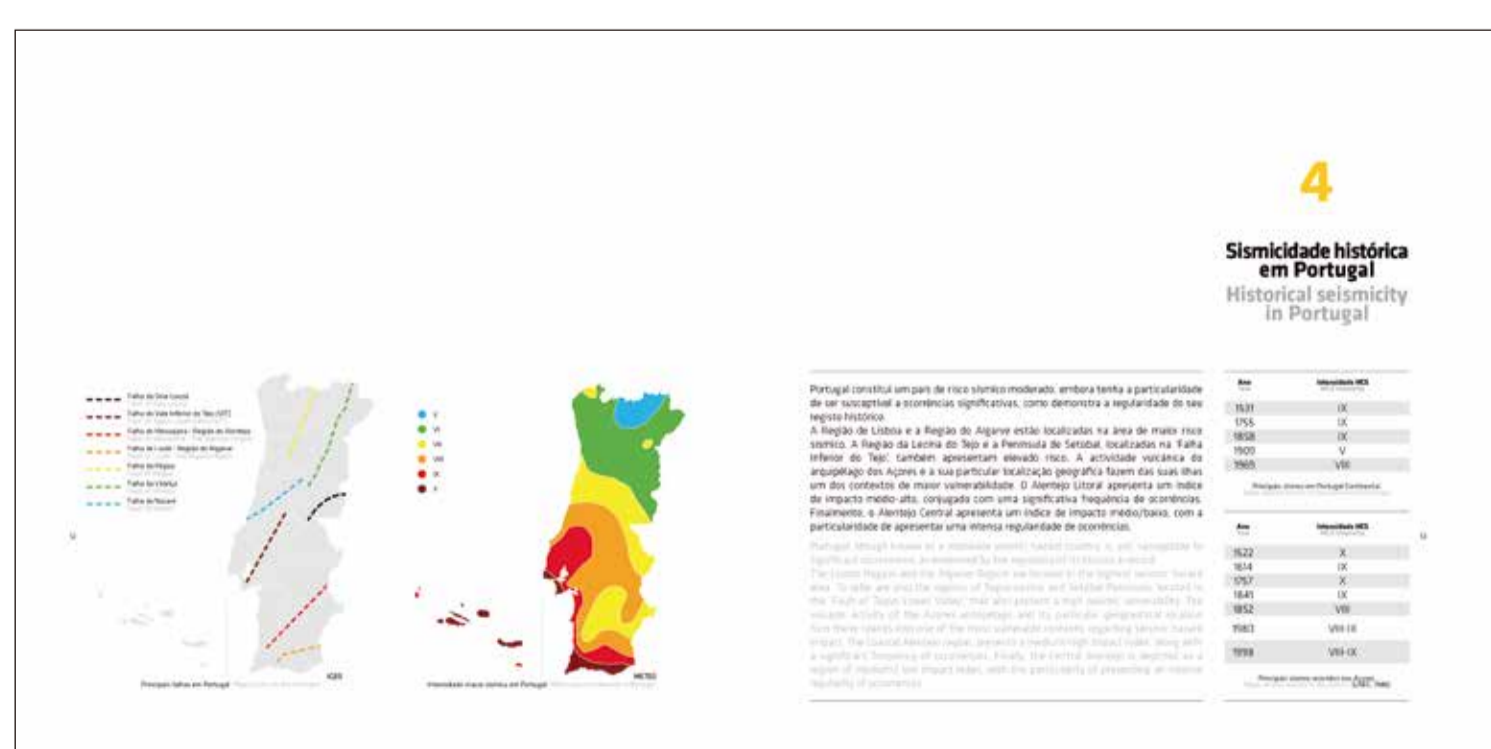

Fig.5-8 SEISMIC-V booklet



Fig.9-13 Images of SEISMIC-V project